

ACTA-EMBRACE® Back Support Order Form



SEATING + POSITIONING

HCPSC CODING: E2613/E2614 - POSITIONING BACK, POSTERIOR

Since U.S. Medicare coding is subject to change, the provider should always confirm the HCPCS code and coverage criteria as part of the client assessment process.

Company Name/ACCT #: _____

P.O. Number: _____

Requested By: _____

Phone: _____ Fax: _____

Email: _____

Ship To: _____

Client Reference: _____



Shown with Compass® 4 Quick Release 2 Point Hardware.
Cover appearance may vary with hardware selection.

This back support is also available through CUSTOM

For best results, do not fill out in your browser. Interactive form should be completed using Adobe Reader after saving to your local drive. Then email or print and fax to Customer Support at orders.comfort@permobil.com or 1.406.522.8563.

DO NOT SEND PROTECTED HEALTH INFORMATION. IT IS NOT NEEDED TO MAKE THE PRODUCT YOU ARE REQUESTING.

1 SIZE SELECTION

Required

BASE MSRP BY SIZE

LENGTH*	22"	\$621.00				\$699.00			
	20"								
	18"	\$546.00				\$638.00			
	16"								
	14"								
	12"								
	10"								
	10"	12"	14"	16"	18"	20"	22"	24"	
	FRAME WIDTH								

Sizes available are subject to hardware being used.

AE-BS

Please fill in the above with dimensions from the size charts to the right.

Example Part: **AE-BS14W16L**

Hardware will be selected in Section 2.

10W10L	12W10L	14W10L	16W10L
--------	--------	--------	--------

Please note these sizes are not available with 4 POINT hardware if using a head support.

IF DESIRED SIZE IS NOT LISTED, PLEASE CONTACT CUSTOMER SUPPORT FOR ASSISTANCE. | 800.736.0925

*Length (L) refers to the actual size dimension of the support from bottom to top edge.

Sizes available with 2 POINT Mounting Hardware

LENGTH*	22"					16W22L	18W22L	20W22L	22W22L
	20"			14W20L	16W20L	18W20L	20W20L	22W20L	
	18"			12W18L	14W18L	16W18L	18W18L	20W18L	
	16"			12W16L	14W16L	16W16L	18W16L	20W16L	
	14"	10W14L	12W14L	14W14L	16W14L	18W14L	20W14L		
	12"	10W12L	12W12L	14W12L	16W12L	18W12L			
	10"	10W10L	12W10L	14W10L	16W10L				
	10"	12"	14"	16"	18"	20"	22"	24"	
	FRAME WIDTH								

Sizes available with 4 POINT Mounting Hardware

LENGTH*	22"					16W22L	18W22L	20W22L	22W22L	24W22L
	20"			14W20L	16W20L	18W20L	20W20L	22W20L	24W20L	
	18"			12W18L	14W18L	16W18L	18W18L	20W18L	22W18L	
	16"			12W16L	14W16L	16W16L	18W16L	20W16L	22W16L	
	14"	10W14L	12W14L	14W14L	16W14L	18W14L	20W14L			
	12"	10W12L	12W12L	14W12L	16W12L	18W12L				
	10"	10W10L	12W10L	14W10L	16W10L					
	10"	12"	14"	16"	18"	20"	22"	24"		
	FRAME WIDTH									

Sizes available with POWER Mounting Hardware

LENGTH*	22"					16W22L	18W22L	20W22L	22W22L	24W22L
	20"			14W20L	16W20L	18W20L	20W20L	22W20L	24W20L	
	18"			12W18L	14W18L	16W18L	18W18L	20W18L	22W18L	
	16"			12W16L	14W16L	16W16L	18W16L	20W16L	22W16L	
	14"			12W14L	14W14L	16W14L	18W14L	20W14L		
	12"			12W12L	14W12L	16W12L	18W12L			
	10"									
	10"	12"	14"	16"	18"	20"	22"	24"		
	FRAME WIDTH									

2 COVER & HARDWARE SELECTION

Required

2.1 COVER SELECTION

MSRP \$0.00

Both fabrics are made without latex. Fabric selection is for the support surface only. Other fabrics used in cover construction remain the same.



COMFORT-TEK® is a smooth, easily cleaned surface. The fluid protection aids in infection control.



STRETCH-AIR® has comfortable stretch, air transmission and heat dissipation. It is not fluid resistant.

COMFORT-TEK Cover
(COMFORT-TEK)

STRETCH-AIR Cover
(STRETCH-AIR)

2.2 HARDWARE STYLE

COMPASS 4 QUICK RELEASE

Price included in back support purchase

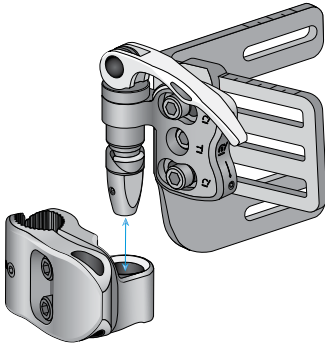

QUICK RELEASE 2 POINT
(Q-COMPASS)

QUICK RELEASE 4 POINT
(Q-COMPASS4)

4 POINT hardware is required on all 24"W back supports using Compass 4 hardware.

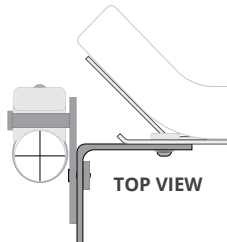

COMPASS 4 FIXED

Price included in back support purchase

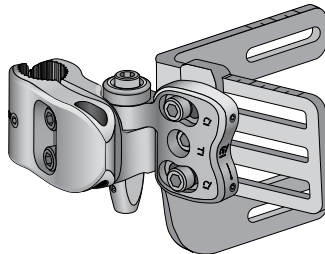

FIXED fully adjustable hardware requires tools for back support removal

FIXED 2 POINT
(NQ-COMPASS)

FIXED 4 POINT
(NQ-COMPASS4)

COMPASS POWER MOUNT

MSRP add \$40.00

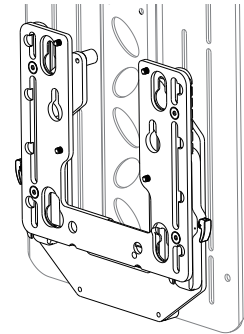

POWER MOUNT hardware has 8" of height adjustment in 1/2" increments without using tools.

QUANTUM w/ TRU BALANCE 3
(PMB-QUANTUM)

PERMOBIL w/ CORPUS 3G
(PMB-PERMOBIL)

QUICKIE w/ 3.7 POWER
(PMB-QUICKIE)

AVID REHAB w/ POWER T & R
(PMB-AVID)

ROVI w/ MOTION CONCEPTS*
(PMB-ROVI)

*Using Power Mount Hardware on ROVI requires mounting to the RECESSED PLANAR INTERFACE PLATE available when ordering the Motion Concepts Seating System. Drilling is required for mounting.

3 BACK SUPPORT ADD-ON SELECTIONS

Optional

3.1 COLOR

MSRP \$26.00

Accent colors are applied via colored piping. Placement of the piping may vary by back support size and mounting hardware. If no colors are selected, our standard silver reflective piping is used at no additional cost.



Color Location

RED (RED)
PURPLE (PURPLE)
PINK (PINK)
BLUE (BLUE)
GREEN (GREEN)
ORANGE (ORANGE)
REMOVE (REMOVE)

3.2 EMBROIDERY

MSRP \$26.00

A. THREAD COLOR OPTIONS

RED (EMB-RED)	BLUE (EMB-BLUE)
PURPLE (EMB-PURPLE)	GREEN (EMB-GREEN)
PINK (EMB-PINK)	SILVER (EMB-SILVER)

B. FONT OPTIONS

Helvetica (EMB-Helvetica)	Twilight (EMB-Twilight)
Garamond (EMB-Garamond)	<i>Script</i> (EMB-Script)

C. WORD ONE
(Input is case sensitive. Please enter exactly as you want the words to look. Example: Marcus or marcus or MARCUS)

WORD TWO (optional)
(Input is case sensitive. Please enter exactly as you want the words to look. Example: Marcus or marcus or MARCUS)

*ADDITIONAL LEAD TIMES MAY APPLY

3.3 PRIVACY FLAP

MSRP \$37.00

This flap connects with hook & loop attachment between the seat and back for added privacy.

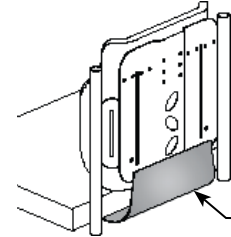

Privacy Flap

PRIVACY FLAP (PV-FLAP)

4 BODILINK LATERAL TRUNK SUPPORT & HARDWARE

4.1 GT2 MOUNTING HARDWARE

Both Fixed and Swing-Away hardware styles are adjustable.

- You may make one selection per column in section 4.1.
- Extra links and long mounting bracket (section 4.8) only for GT2 style hardware.

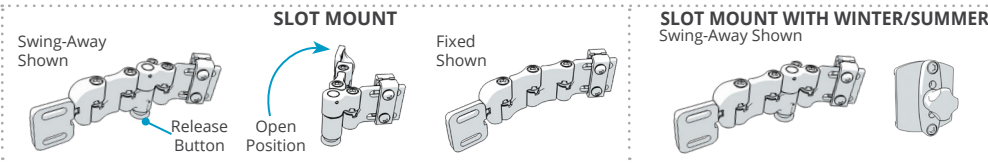

*Additional wings are required for mounting extra lateral hardware. Extra wings only available on Custom Acta-Embrace® in Comfort Designs.

SLOT MOUNTING		MSRP	LEFT		*EXTRA LEFT	RIGHT		*EXTRA RIGHT
OR	SWING-AWAY HCPCS Code: E1028	\$298.00/ea.	BL-LTS-GT2SAS-LH		BL-LTS-GT2SAS-LH	BL-LTS-GT2SAS-RH		BL-LTS-GT2SAS-RH
	FIXED	\$178.00/ea.	BL-LTS-GT2FXS-LH		BL-LTS-GT2FXS-LH	BL-LTS-GT2FXS-RH		BL-LTS-GT2FXS-RH
SLOT w/ WINTER/SUMMER		MSRP	LEFT		RIGHT			
OR	SWING-AWAY HCPCS Code: E1028	\$452.00/ea.	BL-LTS-GT2SAWSAE-LH		BL-LTS-GT2SAWSAE-RH			
	FIXED	\$332.00/ea.	BL-LTS-GT2FXWSAE-LH		BL-LTS-GT2FXWSAE-RH			

4.2

PREMIUM PAD SIZE & SHAPE

HCPCS Code: E0956 MSRP \$88.00/ea.

- You may make one selection per column in section 4.2.
- Follow each column down to sections 4.3 and 4.4 and select a style and cover for each pad selected in section 4.2.

*Length (L) refers to the dimension of the support from top to bottom edge. Depth (D) refers to the dimension of the support from anterior to posterior edge.

	SHAPE	SIZE	LEFT	*EXTRA LEFT	RIGHT	*EXTRA RIGHT
SUPPORTIVE		3"L x 4"D	BL-LTSP2S-3L4D-LH	BL-LTSP2S-3L4D-LH	BL-LTSP2S-3L4D-RH	BL-LTSP2S-3L4D-RH
		3"L x 5.5"D	BL-LTSP2S-3L5D-LH	BL-LTSP2S-3L5D-LH	BL-LTSP2S-3L5D-RH	BL-LTSP2S-3L5D-RH
		4"L x 5"D	BL-LTSP2S-4L5D-LH	BL-LTSP2S-4L5D-LH	BL-LTSP2S-4L5D-RH	BL-LTSP2S-4L5D-RH
		4"L x 6.5"D	BL-LTSP2S-4L6D-LH	BL-LTSP2S-4L6D-LH	BL-LTSP2S-4L6D-RH	BL-LTSP2S-4L6D-RH
		5"L x 6.5"D	BL-LTSP2S-5L6D-LH	BL-LTSP2S-5L6D-LH	BL-LTSP2S-5L6D-RH	BL-LTSP2S-5L6D-RH
		6"L x 6.5"D	BL-LTSP2S-6L6D-LH	BL-LTSP2S-6L6D-LH	BL-LTSP2S-6L6D-RH	BL-LTSP2S-6L6D-RH
ACTIVE		3"L x 4"D	BL-LTSP2A-3L4D-LH	BL-LTSP2A-3L4D-LH	BL-LTSP2A-3L4D-RH	BL-LTSP2A-3L4D-RH
		3"L x 5.5"D	BL-LTSP2A-3L5D-LH	BL-LTSP2A-3L5D-LH	BL-LTSP2A-3L5D-RH	BL-LTSP2A-3L5D-RH
		4"L x 5"D	BL-LTSP2A-4L5D-LH	BL-LTSP2A-4L5D-LH	BL-LTSP2A-4L5D-RH	BL-LTSP2A-4L5D-RH
		4"L x 6.5"D	BL-LTSP2A-4L6D-LH	BL-LTSP2A-4L6D-LH	BL-LTSP2A-4L6D-RH	BL-LTSP2A-4L6D-RH
		5"L x 6.5"D	BL-LTSP2A-5L6D-LH	BL-LTSP2A-5L6D-LH	BL-LTSP2A-5L6D-RH	BL-LTSP2A-5L6D-RH
		6"L x 6.5"D	BL-LTSP2A-6L6D-LH	BL-LTSP2A-6L6D-LH	BL-LTSP2A-6L6D-RH	BL-LTSP2A-6L6D-RH

4.3

PREMIUM PAD STYLE

MSRP \$0.00/ea.

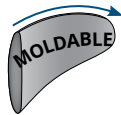

OR

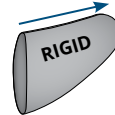

*Additional wings are required for mounting extra lateral hardware. Extra wings only available on Custom Acta-Embrace® in Comfort Designs.

STYLE OPTIONS	LEFT	*EXTRA LEFT	RIGHT	*EXTRA RIGHT
MOLDABLE	LTS-P2-MOLD	LTS-P2-MOLD	LTS-P2-MOLD	LTS-P2-MOLD
RIGID	LTS-P2-RIGID	LTS-P2-RIGID	LTS-P2-RIGID	LTS-P2-RIGID

4.4

PREMIUM PAD COVER

- COMFORT-TEK** FOR FLUID PROTECTION & AN EASILY CLEANED SURFACE.
- STRETCH-AIR** FOR COMFORT & HEAT DISSIPATION.
- GLIDEWEAR™** FOR SKIN PROTECTION & SHEAR REDUCTION. NOT FLUID RESISTANT.
- COVER with FOAM** FOR SOFT FEEL AND ADDITIONAL CUSHIONING SUPPORT.

COVER OPTIONS	MSRP	LEFT	*EXTRA LEFT	RIGHT	*EXTRA RIGHT
NO COVER	\$0.00/ea.	LTS-P2-NO-CV	LTS-P2-NO-CV	LTS-P2-NO-CV	LTS-P2-NO-CV
COMFORT-TEK	\$0.00/ea.	LTS-P2-COMFORT	LTS-P2-COMFORT	LTS-P2-COMFORT	LTS-P2-COMFORT
STRETCH-AIR	\$0.00/ea.	LTS-P2-STRETCH	LTS-P2-STRETCH	LTS-P2-STRETCH	LTS-P2-STRETCH
GLIDEWEAR™	\$13.00/ea.	LTS-P2-GLIDE	LTS-P2-GLIDE	LTS-P2-GLIDE	LTS-P2-GLIDE
COMFORT-TEK with FOAM	\$13.00/ea.	LTS-P2-COMFORT-FM	LTS-P2-COMFORT-FM	LTS-P2-COMFORT-FM	LTS-P2-COMFORT-FM
STRETCH-AIR with FOAM	\$13.00/ea.	LTS-P2-STRETCH-FM	LTS-P2-STRETCH-FM	LTS-P2-STRETCH-FM	LTS-P2-STRETCH-FM
GLIDEWEAR with FOAM	\$26.00/ea.	LTS-P2-GLIDE-FM	LTS-P2-GLIDE-FM	LTS-P2-GLIDE-FM	LTS-P2-GLIDE-FM

ACTA-EMBRACE-ORDER REV1 20320

4.5

BASIC PAD SIZE & SHAPE

HCPCS Code: E0956 MSRP \$82.00/ea.

- You may make one selection per column in section 4.5.
- Follow each column down to sections 4.6 and 4.7 and select a style and cover for each pad selected in section 4.5.

*Length (L) refers to the actual size dimension of the support from top to bottom edge. Depth (D) refers to the actual size dimension from anterior to posterior edge.

	SHAPE	SIZE	LEFT	*EXTRA LEFT	RIGHT	*EXTRA RIGHT
SUPPORTIVE		3"L x 4"D	BL-LTSP1S-3L4D-LH	BL-LTSP1S-3L4D-LH	BL-LTSP1S-3L4D-RH	BL-LTSP1S-3L4D-RH
		3"L x 5"D	BL-LTSP1S-3L5D-LH	BL-LTSP1S-3L5D-LH	BL-LTSP1S-3L5D-RH	BL-LTSP1S-3L5D-RH
		4"L x 5"D	BL-LTSP1S-4L5D-LH	BL-LTSP1S-4L5D-LH	BL-LTSP1S-4L5D-RH	BL-LTSP1S-4L5D-RH
		4"L x 6"D	BL-LTSP1S-4L6D-LH	BL-LTSP1S-4L6D-LH	BL-LTSP1S-4L6D-RH	BL-LTSP1S-4L6D-RH
		5"L x 7"D	BL-LTSP1S-5L7D-LH	BL-LTSP1S-5L7D-LH	BL-LTSP1S-5L7D-RH	BL-LTSP1S-5L7D-RH
		6"L x 6"D	BL-LTSP1S-6L6D-LH	BL-LTSP1S-6L6D-LH	BL-LTSP1S-6L6D-RH	BL-LTSP1S-6L6D-RH
OR	ACTIVE		BL-LTSP1A-3L4D-LH	BL-LTSP1A-3L4D-LH	BL-LTSP1A-3L4D-RH	BL-LTSP1A-3L4D-RH
			BL-LTSP1A-3L5D-LH	BL-LTSP1A-3L5D-LH	BL-LTSP1A-3L5D-RH	BL-LTSP1A-3L5D-RH
			BL-LTSP1A-4L5D-LH	BL-LTSP1A-4L5D-LH	BL-LTSP1A-4L5D-RH	BL-LTSP1A-4L5D-RH
			BL-LTSP1A-4L6D-LH	BL-LTSP1A-4L6D-LH	BL-LTSP1A-4L6D-RH	BL-LTSP1A-4L6D-RH
			BL-LTSP1A-5L7D-LH	BL-LTSP1A-5L7D-LH	BL-LTSP1A-5L7D-RH	BL-LTSP1A-5L7D-RH
			BL-LTSP1A-6L6D-LH	BL-LTSP1A-6L6D-LH	BL-LTSP1A-6L6D-RH	BL-LTSP1A-6L6D-RH

Contact Customer Support for custom sizes. 800.736.0925.

*"EXTRA" parts may not fit depending on back support, pad, and hardware size and style combinations. Please contact customer support with questions.

4.6

BASIC PAD STYLE

MSRP \$0.00/ea.

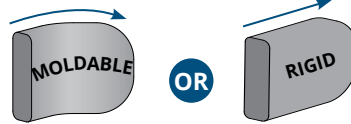

	STYLE OPTIONS	LEFT	*EXTRA LEFT	RIGHT	*EXTRA RIGHT
OR	MOLDABLE	LTS-P1-MOLD	LTS-P1-MOLD	LTS-P1-MOLD	LTS-P1-MOLD
	RIGID	LTS-P1-RIGID	LTS-P1-RIGID	LTS-P1-RIGID	LTS-P1-RIGID

4.7

BASIC PAD COVER

MSRP \$0.00/ea.



	COVER OPTIONS	LEFT	*EXTRA LEFT	RIGHT	*EXTRA RIGHT
OR	COMFORT-TEK	LTS-P1-COMFORT	LTS-P1-COMFORT	LTS-P1-COMFORT	LTS-P1-COMFORT
	STRETCH-AIR	LTS-P1-STRETCH	LTS-P1-STRETCH	LTS-P1-STRETCH	LTS-P1-STRETCH

4.8

GT2 ADDITIONAL OPTIONS

	EXTRA HARDWARE LINKS MSRP \$37.00/link	LEFT BL-LTS-GT2LINK	ADD'L LEFT BL-LTS-GT2LINK	RIGHT BL-LTS-GT2LINK	ADD'L RIGHT BL-LTS-GT2LINK
	LONG MOUNTING BRACKET For Slot Mount MSRP \$37.00/ea	LEFT BL-LTS-GT2LSLOT-LH	*EXTRA LEFT BL-LTS-GT2LSLOT-LH	RIGHT BL-LTS-GT2LSLOT-RH	*EXTRA RIGHT BL-LTS-GT2LSLOT-RH
	HARDWARE COVER MSRP \$26.00/ea	LEFT BL-LTS-HCOVER	*EXTRA LEFT BL-LTS-HCOVER	RIGHT BL-LTS-HCOVER	*EXTRA RIGHT BL-LTS-HCOVER
	WINTER/SUMMER HARDWARE MSRP \$154.00/ea	LEFT BL-LTS-HWSAE-LH		RIGHT BL-LTS-HWSAE-RH	

5 BODILINK® HEAD SUPPORT HARDWARE & PADS

- You may make one selection per column.
- Choose pad firmness and size in 5.1.
- Choose a cover material in 5.2.

5.1 PREMIUM PAD SIZE

HCPCS CODING: E0955 MSRP \$237.00

Length (L) refers to the actual size dimension of the support from bottom to top edge.

		Pad Firmness	
L		Soft	BL-HSP1-6W3L
		Extra Soft	BL-HSP2-6W3L
L		Soft	BL-HSP1-8W4L
		Extra Soft	BL-HSP2-8W4L
L		Soft	BL-HSP1-10W5L
		Extra Soft	BL-HSP2-10W5L
L		Soft	BL-HSP1-12W5L
		Extra Soft	BL-HSP2-12W5L
L		Soft	BL-HSP1-14W5L
		Extra Soft	BL-HSP2-14W5L
L		Soft	BL-HSP1-18W5L
		Extra Soft	BL-HSP2-18W5L



Premium Head Support Pads angles can be formed by adjusting the plates in the pad.

5.2 PREMIUM PAD COVER MATERIAL

GlideWear technology

FOR SKIN PROTECTION & SHEAR REDUCTION. NOT FLUID RESISTANT.

COMFORT-TEK

FOR FLUID PROTECTION & AN EASILY CLEANED SURFACE.

STRETCH-AIR

FOR COMFORT.

	GlideWear (GLIDEWEAR) (add \$26.00)
	COMFORT-TEK (COMFORT-TEK)
	STRETCH-AIR (STRETCH-AIR)

5.3 PT HARDWARE

- You may make one selection per column.
- Choose PT hardware type in 5.3 A or B.
- If choosing A, select a stem size immediately after.

RANGE OF MOTION

PT MODEL	TOTAL # OF LINKS	TOTAL LINK LENGTH	MAX ANTERIOR REACH	MAX POSTERIOR REACH	MAX LATERAL REACH
MID 6	2	6"	5.5"	1"	N/A
LAT 6	3	6"	5.5"	1"	6"
MID 8	2	8"	7.5"	1"	N/A
LAT 8	3	8"	7.5"	1"	8"
MAX 8	4	8"	7.5"	3"	8"

A. PT HARDWARE, REMOVABLE

HCPCS E1028

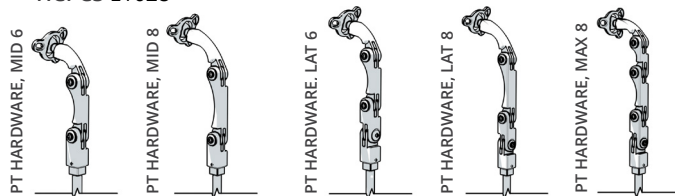

SHAPE	MSRP	PART NUMBER
MID 6	\$223.00	(BL-HS-PT1RMMID6)
LAT 6	\$260.00	(BL-HS-PT1RMLAT6)
MID 8	\$223.00	(BL-HS-PT1RMMID8)
LAT 8	\$260.00	(BL-HS-PT1RMLAT8)
MAX 8*	\$327.00	(BL-HS-PT1RMMAX8)

*Provides the greatest amount of articulation and range of motion.

PT HARDWARE, REMOVABLE, STEM LENGTH OPTION

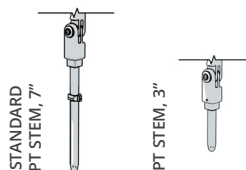

STEM LENGTH	MSRP	PART NUMBER
STANDARD 7" STEM	\$0.00	(HS-STEM-7)
**3" STEM	\$0.00	(HS-STEM-3)

**3" Stem is recommended for use with power mounting where there may be special constraints with power chair functions.

B. PT HARDWARE, FLIP-DOWN

HCPCS E1028

Flip-Down Hardware has 7" Stem

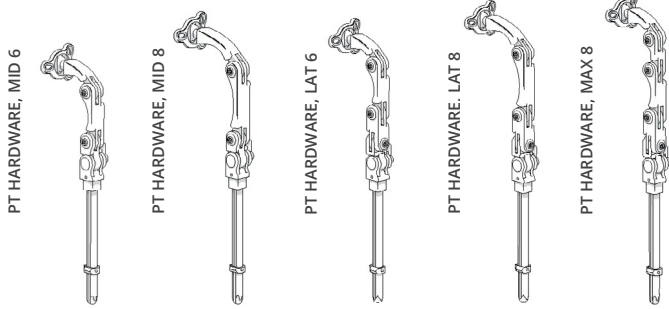

SHAPE	MSRP	PART NUMBER
MID 6	\$273.00	(BL-HS-PT1FDMID6)
LAT 6	\$310.00	(BL-HS-PT1FDLAT6)
MID 8	\$273.00	(BL-HS-PT1FDMID8)
LAT 8	\$310.00	(BL-HS-PT1FDLAT8)
MAX 8*	\$357.00	(BL-HS-PT1FDMAX8)

*Provides the greatest amount of articulation and range of motion.

5.4 HEAD SUPPORT MOUNTING OPTION



MOUNTING BLOCK-POSTERIOR A

MOUNTING BLOCK OR BRACKET	MSRP	PART NUMBER
POSTERIOR A MOUNTING BLOCK	\$0.00	(HS-MB-POSTA)

5.5 EXTRA HARDWARE



LINK LENGTH	MSRP	EXTRA PART
*EXTRA 2" LINK	\$57.00	(BL-HS-PT1LINK2)



*EXTRA 3" LINK	\$57.00	(BL-HS-PT1LINK3)
----------------	---------	------------------



*EXTRA 4" LINK	\$57.00	(BL-HS-PT1LINK4)
----------------	---------	------------------

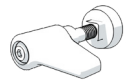

TOOL-LESS WING LOCK	MSRP	EXTRA PART	EXTRA PART	EXTRA PART	EXTRA PART
*1 LOCK	\$21.00/each	(BL-HS-52WINGA1)	(BL-HS-52WINGA1)	(BL-HS-52WINGA1)	(BL-HS-52WINGA1)



ADDITIONAL	MSRP	EXTRA PART
1/4" SPACER PLATE	\$37.00/each	(BL-HS-SPCRA)

*FOR PT HARDWARE ONLY

6 STRAP GUIDE EXTENSION

Optional

6.1 STRAP GUIDE EXTENSION BRACKET

MSRP \$61.00/set

SIZE
Extra Small (up to 1 1/2" w webbing) (CHG2-EB1)
Small (up to 2 1/4" w webbing) (CHG2-EB2)

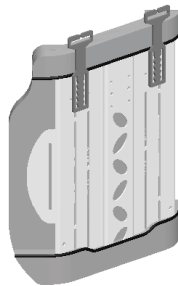

The following are trademarks and registered trademarks of Permobil Seating and Positioning: ACTA-EMBRACE®, BodiLink®, COMFORT-TEK®, Compass®, and STRETCH-AIR®. GlideWear™ is a trademark of MIPS.

ACTA-EMBRACE ORDER FORM

Client Reference: _____

DO NOT SEND PROTECTED HEALTH INFORMATION. IT IS NOT NEEDED TO MAKE THE PRODUCT YOU ARE REQUESTING.

SUBMIT BY EMAIL

PAGE 7 of 6

ACTA-EMBRACE-ORDER REV120320